



www.keencut.com
+44 (0) 1536 263158
+1 (716) 748 6203

sales@keencut.co.uk (UK HQ)
sales@keencut.com (US sales)

The world's finest cutting machines

Scan the QR code or
[click here to view this document online >](#)



Contents

1. Before you start	3
1.1 Assembly time	3
1.2 Be careful when lifting	4
1.3 Components	5
1.4 Tools included	8
1.5 Tools not included	9
1.6 Extra tools needed if you are not using a SmartFold Bench	10
1.7 Symbols and icons	11
1.8 Which bench are you fixing to?	12
2. Option 1 - fix your cutter to an Evolution3 SmartFold Bench	13
2.1 Fix the base brackets to your Keencut Bench	13
2.2 Fix the cutter to the base brackets on your Keencut Bench	15
2.3 Attach the cutter arms to your Evolution3 SmartFold Bench	17
2.4 Attach the cutter arms to your Evolution E2 Bench	20
3. Option 2 -fix your cutter to a non-Keencut bench	24
3.1 Workspace required	24
3.2 Work bench flatness test and requirements	25
3.3 Fix the base brackets to your non-Keencut bench	27
3.4 Fix the cutter to the base brackets on your non-Keencut Bench	29
3.5 Attach the cutter arms to your non-Keencut Bench	31
4. Finish Assembly and Calibration	34
4.1 Fit the Lift-and-Hover levers	34
4.2 Hover action adjustment	36
4.3 Clamp adjustment	38
4.4 Remove cutter bar sag	41
5. Using your machine	42
5.1 Register your machine	42
5.2 User guide	43



www.keencut.com
+44 (0) 1536 263158
+1 (716) 748 6203

sales@keencut.co.uk (UK HQ)
sales@keencut.com (US sales)

The world's finest cutting machines

Scan the QR code or
[click here to view this document online >](#)



1. Before you start

1.1 Assembly time



You will need approximately 2 hours to install and calibrate your cutter



www.keencut.com
+44 (0) 1536 263158
+1 (716) 748 6203

sales@keencut.co.uk (UK HQ)
sales@keencut.com (US sales)

The world's finest cutting machines

Scan the QR code or
[click here to view this document online >](#)



1.2 Be careful when lifting



To prevent injury and damage, lift the box and the machine with 2 people



1.3 Components

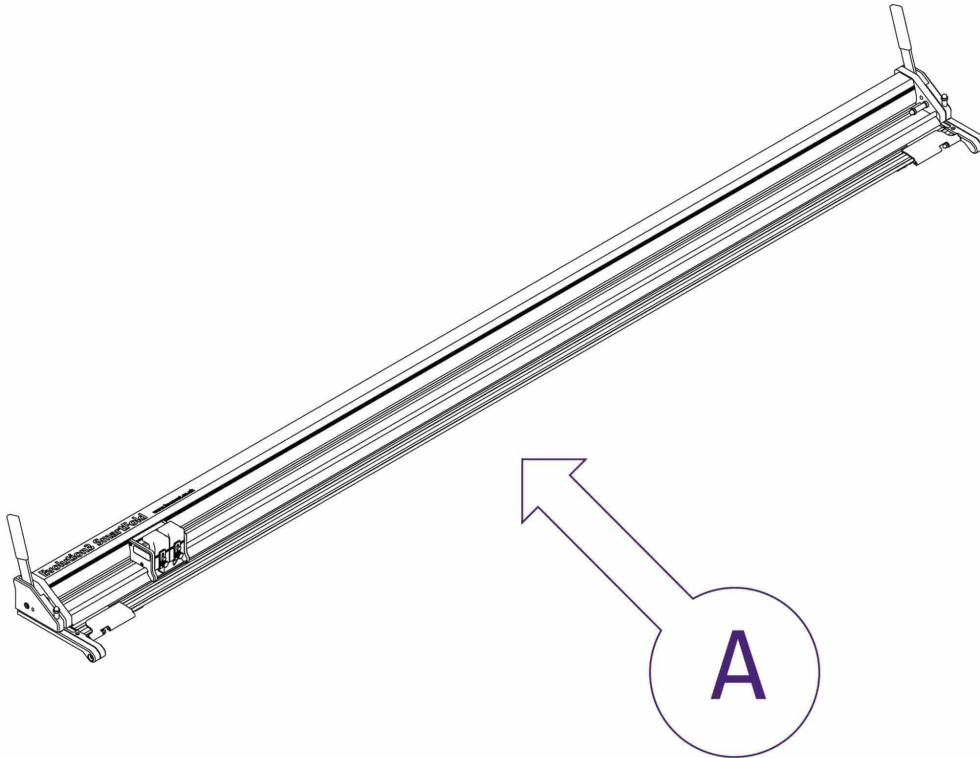

The Evolution3 SmartFold (part A) comes in 9 different sizes ranging from 1.1m (44") to 5.1m (204") (cutting length) in 0.5m (20") increments. Each machine is fitted with a Double Graphik blade cutting head.



www.keencut.com
+44 (0) 1536 263158
+1 (716) 748 6203

sales@keencut.co.uk (UK HQ)
sales@keencut.com (US sales)

The world's finest cutting machines

Scan the QR code or
[click here to view this document online >](#)



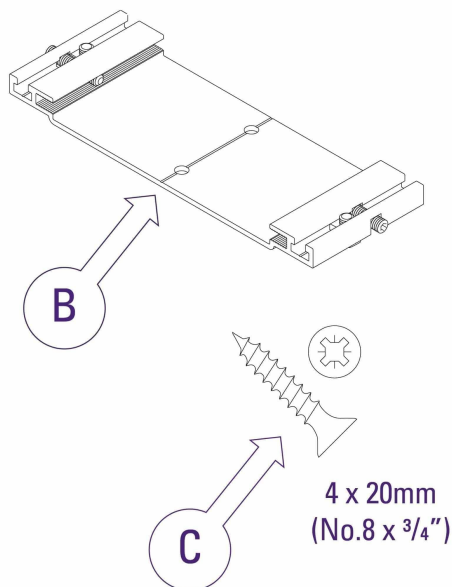

E3SF110:	3 x B	6 x C
E3SF160:	4 x B	8 x C
E3SF210:	5 x B	10 x C
E3SF260:	6 x B	12 x C
E3SF310:	7 x B	14 x C
E3SF360:	8 x B	16 x C
E3SF410:	9 x B	18 x C
E3SF460:	10 x B	20 x C
E3SF510:	11 x B	22 x C

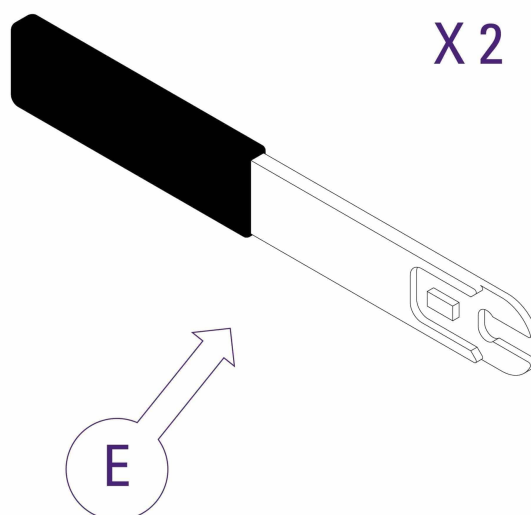
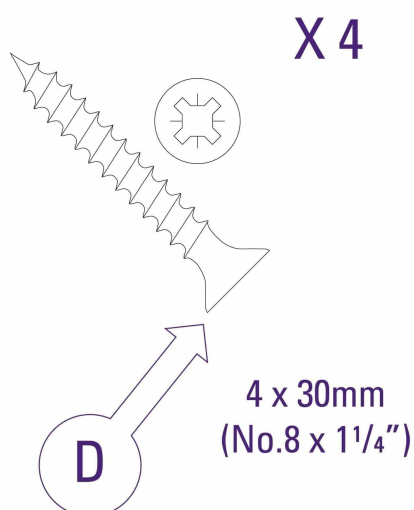

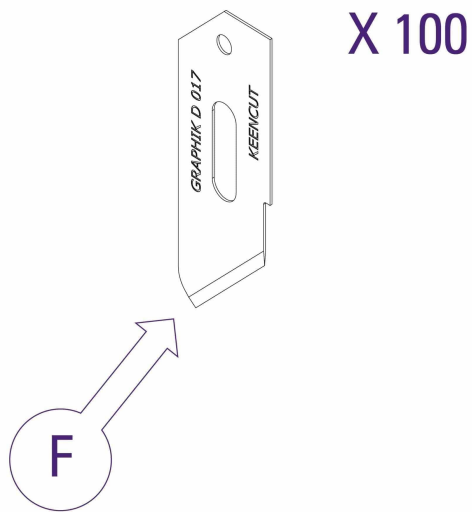

1.4 Tools included



1.5 Tools not included

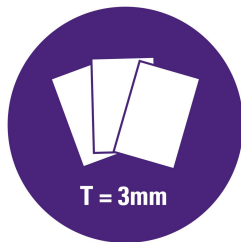

3 x strips of ACP or PVC foamboard



A sheet of A4/letter size paper.

The three pieces of ACP (aluminium composite panel) or PVC foamboard should be approximately 150mm x 100mm (6" x 4") and 3mm ($\frac{3}{8}$ ") thick.



1.6 Extra tools needed if you are not using a SmartFold Bench

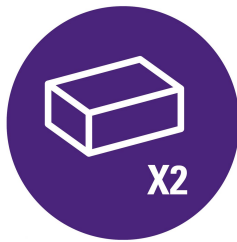

2 blocks of wood (or similar) of equal size



2 equal weights



Thread



1.7 Symbols and icons



Muscle = do this firmly



Feather = do this gently



Be careful when lifting



1.8 Which bench are you fixing to?

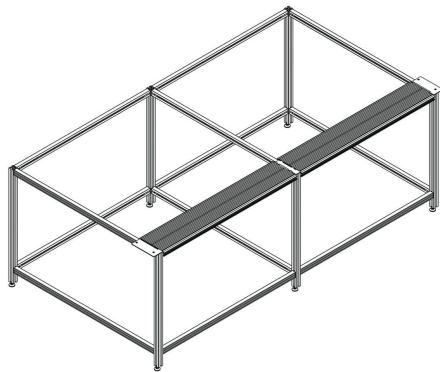

Keencut Evolution3 SmartFold Bench

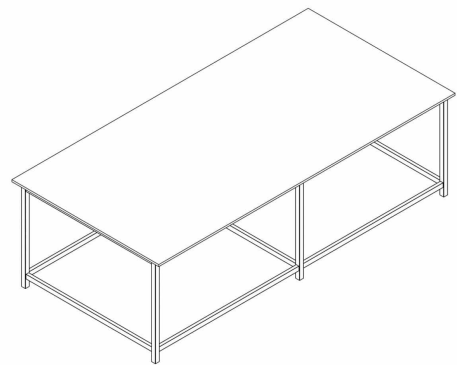

Non-Keencut Bench

See section 2 to fix your machine to an Evolution3 SmartFold Bench >

See section 3 to fix your machine to a non-Keencut bench >



2. Option 1 - fix your cutter to an Evolution3 SmartFold Bench

2.1 Fix the base brackets to your Keencut Bench

See how to fix the base brackets to you Keencut Bench in this video >

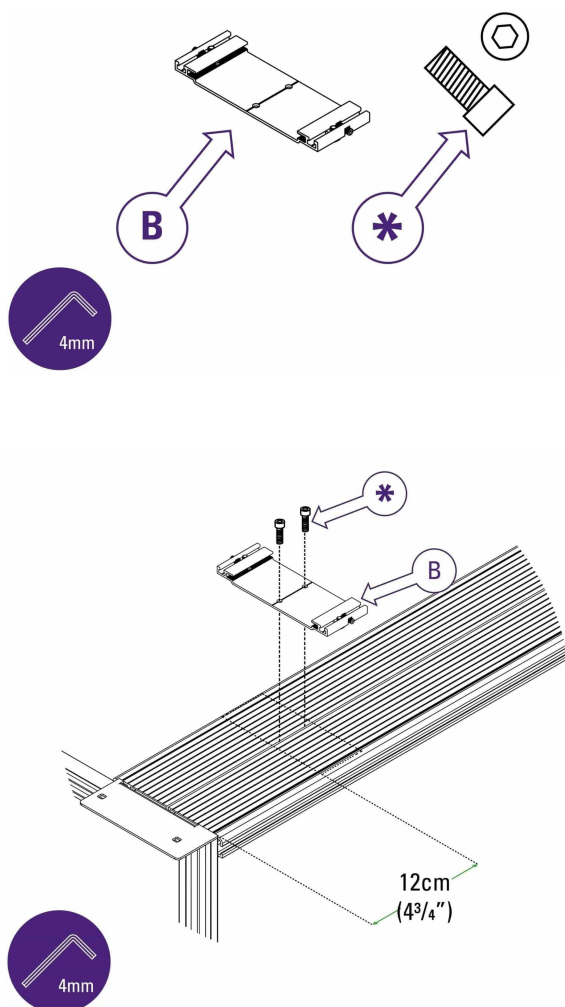

In this section you will need base brackets (part B) and short socket head screws (part * – delivered with the SmartFold Bench).

Place the first base bracket (part B) 12cm (4 3/4") from the edge of your SmartFold Bench. Use the 4mm Allen (hex) key to tighten screws (part *).



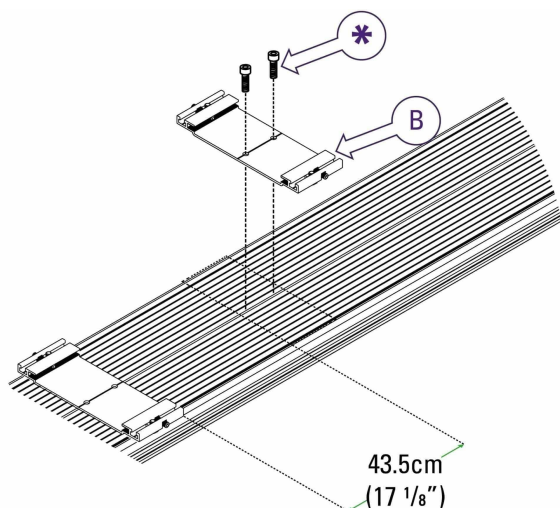

Place the following base brackets (part B) 43.5cm (17 1/8") from the edge of the previous base bracket. Use the 4mm Allen (hex) key to tighten screws (part *).

Continue placing the rest of the base brackets in this way.



2.2 Fix the cutter to the base brackets on your Keencut Bench

See how to fix the cutter to a Keencut bench in this video >

IMPORTANT: This step should be carried out by two people to prevent damage or injury

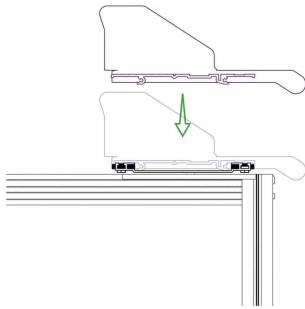

Centralise and lower the cutter slowly onto the base brackets.

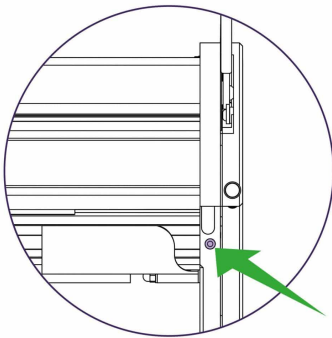

Ensure the holes on the arms of the cutter (highlighted in image) are aligned with the holes in the benches support plates.

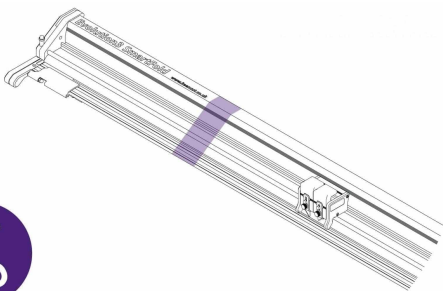

Once the SmartFold is in place, use scissors to remove the film packaging.



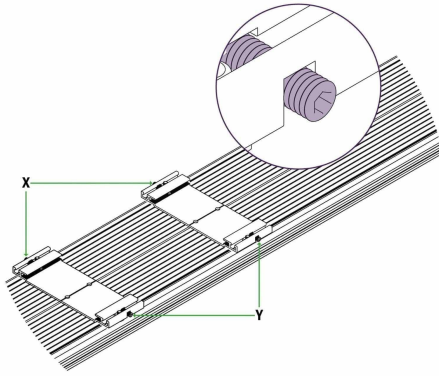

The base brackets have 2 grub screws each located at the front and the back (see 'x' and 'y').

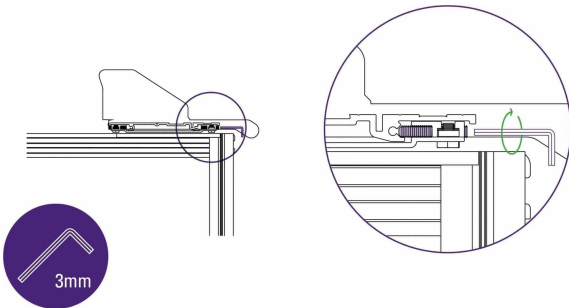

Use the long end of the 3mm Allen (hex) key rotate the grub screws in the front of the base brackets until you feel them come to a stop, do not tighten any further.



Do this gently

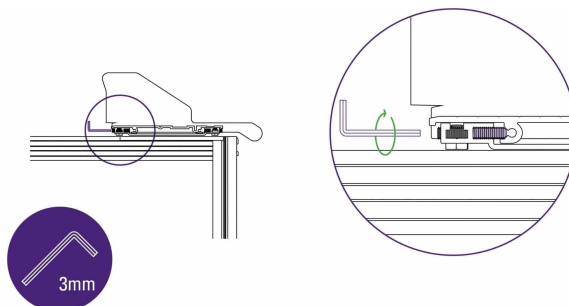

Repeat the process on the grub screws at the back of the base brackets.



Do this gently

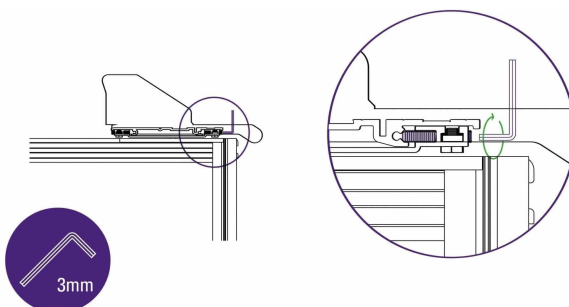

Use the 3mm Allen (hex) key to firmly tighten the grub screws in the front of the base brackets.



Do this firmly



2.3 Attach the cutter arms to your Evolution3 SmartFold Bench

If you are attaching your SmartFold to an Evolution E2 Bench [see section 2.4](#) to find out how to attach the cutter arms to an Evolution E2 Bench >

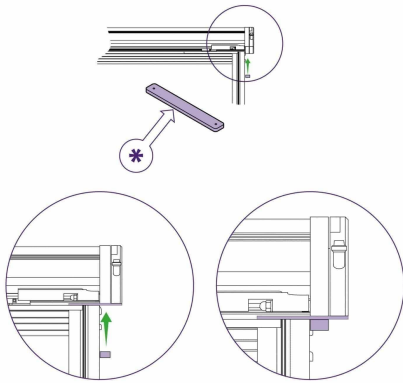

If the black brackets support both arms of the cutter use the black steel bar (part * – supplied with the SmartFold Bench).

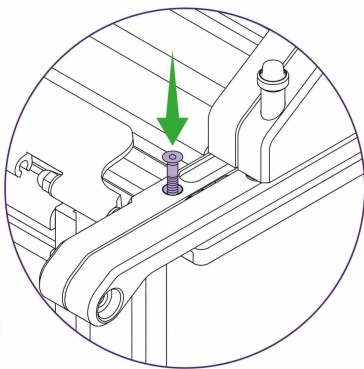

Pass the long countersink screw (supplied with the bench) through the arm and black support bracket then use the 3mm Allen (hex) key to loosely attach into the clamp bar. Repeat the step on the other side of your machine.



Do this gently

IMPORTANT: It is essential to remove cutter head before folding



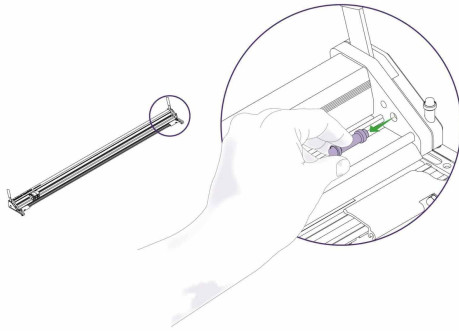

Pull and remove end stop.

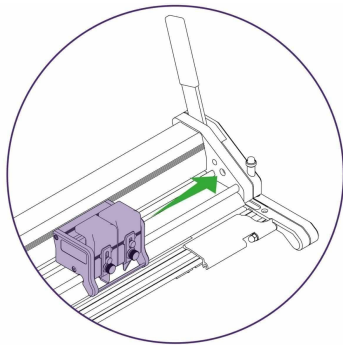

Slide the cutting head to the right.

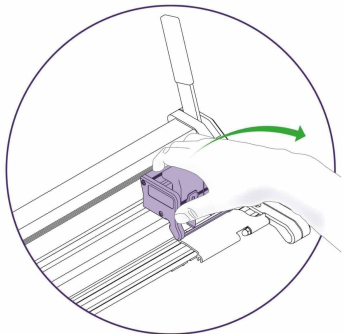

Gently lift to remove the cutter head, then replace end stop.

IMPORTANT: This next step may require more than one person on longer cutters to prevent damage or injury



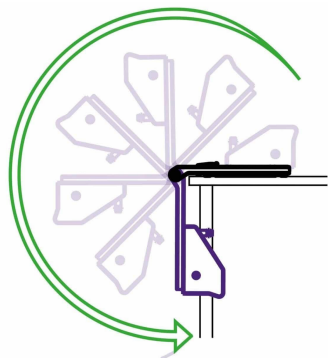

Grip the cutter bar firmly, lift carefully and swing over the edge of the bench, bring gently to a stop when vertical.



Be careful when lifting

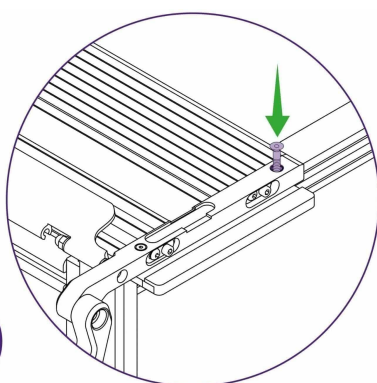

Insert long countersink screw (supplied with the bench) but do not fully tighten. Repeat this step on the other side of your SmartFold.



Do this gently

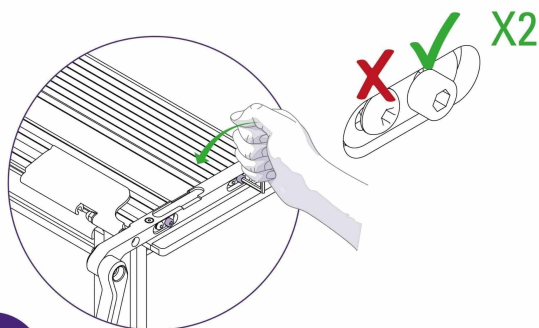

Use 4mm Allen (hex) Key to loosen the cap screws by one full turn at the end of the SmartFold.

DO NOT loosen the domed head screws that have red paint on them.

Repeat this step on the other end of your SmartFold.

Next step:

4. Finish assembly and calibration >



2.4 Attach the cutter arms to your Evolution E2 Bench

If you are attaching your SmartFold to an Evolution3 SmartFold Bench see section 2.3 to find out how to attach the cutter arms to an Evolution3 SmartFold Bench >

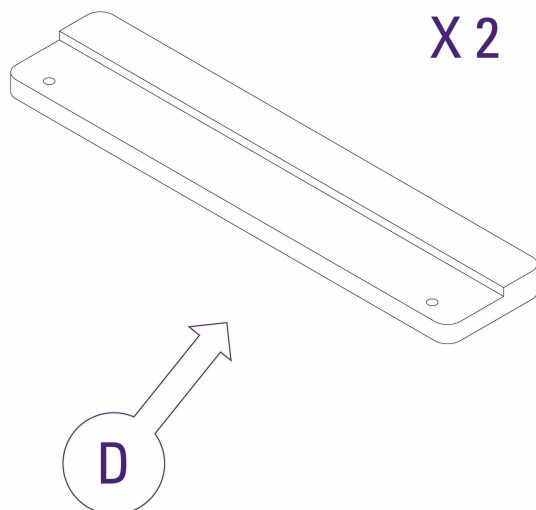

You will need this part to attach your SmartFold to an Evolution2 Bench.

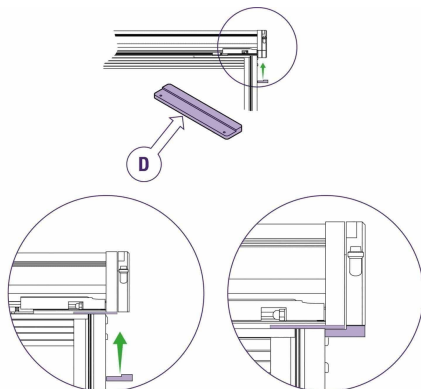

Lift the stepped clamp bar (part D) into position as shown.



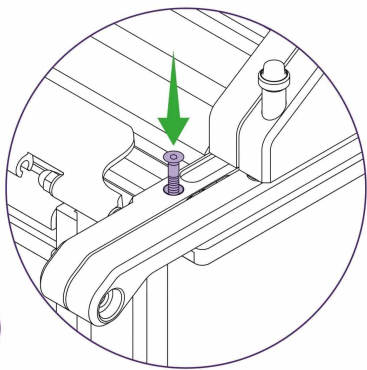

Pass the long countersink screw (supplied with the bench) through the arm and black support bracket then use the 3mm Allen (hex) key to loosely attach into the clamp bar. Repeat the step on the other side of your machine.



Do this gently

IMPORTANT: It is essential to remove cutter head before folding

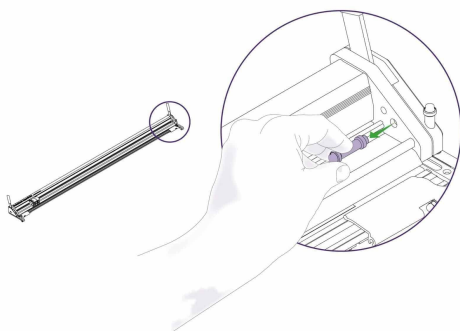

Pull and remove end stop.

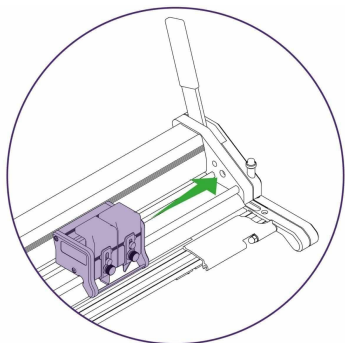

Slide the cutting head to the right.



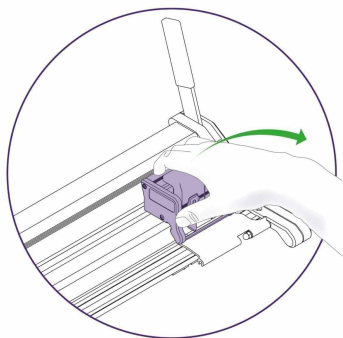

Gently lift to remove the cutter head, then replace end stop.

IMPORTANT: This next step may require more than one person on longer cutters to prevent damage or injury

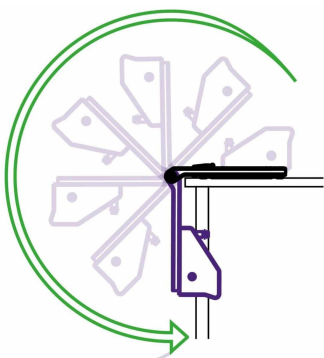

Grip the cutter bar firmly, lift carefully and swing over the edge of the bench, bring gently to a stop when vertical.



Be careful when lifting

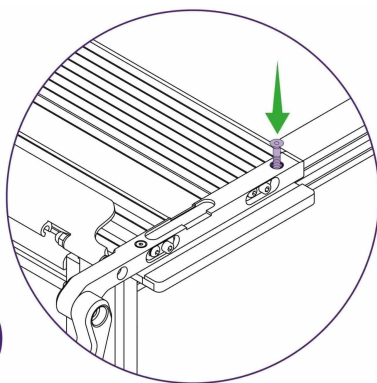

Insert long countersink screw (supplied with the bench) but do not fully tighten. Repeat this step on the other side of your SmartFold.



Do this gently



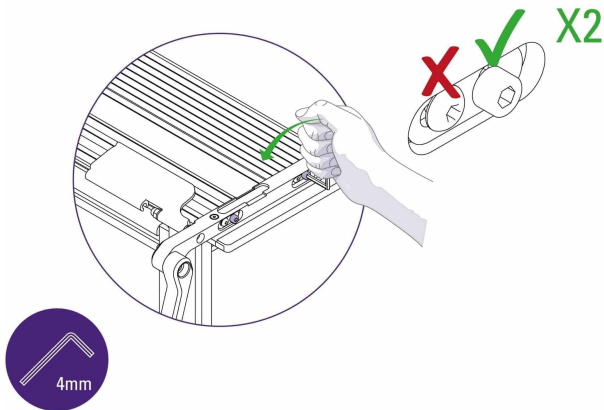

Use 4mm Allen (hex) Key to loosen the cap screws by one full turn at the end of the SmartFold.

DO NOT loosen the domed head screws that have red paint on them.

Repeat this step on the other end of your SmartFold.

Next step:

[4. Finish assembly and calibration >](#)



3. Option 2 -fix your cutter to a non-Keencut bench

3.1 Workspace required

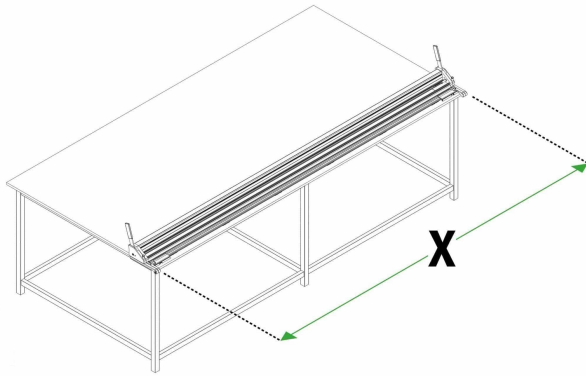

The width of the work surface needs to be 40cm (15 ¾") wider than the cut length of the SmartFold.

Example: E3SF260 (104") + 40cm (15 ¾") = 300cm (118") work bench



3.2 Work bench flatness test and requirements

If your workbench does not meet the following parameters and cannot be adjusted for flatness it is recommended to use a different bench. Keencut's BenchTop Bench is designed especially for this purpose.



Check the flatness of the worktop by stretching a thin piece of strong thread between two blocks of the same height approximately over the area the cutter is to be mounted.

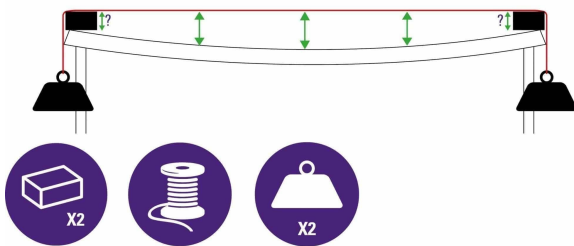

Measure the highest and lowest part of the worktop under the thread, the difference between the two measurements should be no more than 3mm ($\frac{1}{8}$ "). If it is greater it will be necessary to adjust the surface flatness with a new top or by using spacing pieces under those base brackets (part B) that require it when they are installed.

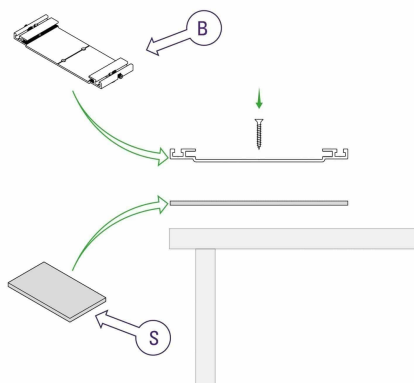

The spacing pieces (part S) should be made from 1.5mm – 3mm ($\frac{1}{16}$ " – $\frac{1}{8}$ ") thick rigid material such as ACP or PVC Foamboard cut to the same size as the base bracket and placed under the base brackets (part B) as they are installed (next section).



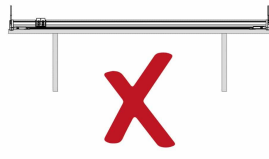

The work surface must be stable with a robust framework below and good support (no flexing) in the area under the two ends of the cutter.

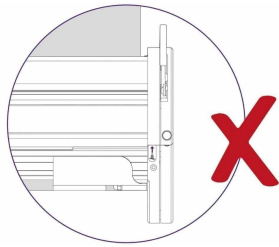
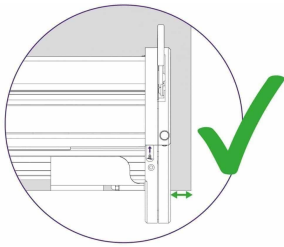

Both ends of the cutter must be fully supported and not overhanging the work surface.



3.3 Fix the base brackets to your non-Keencut bench

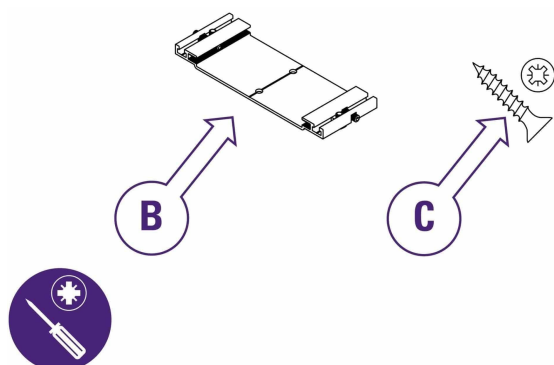

In this section you will need base brackets (part B) and short posi head screws (part C).

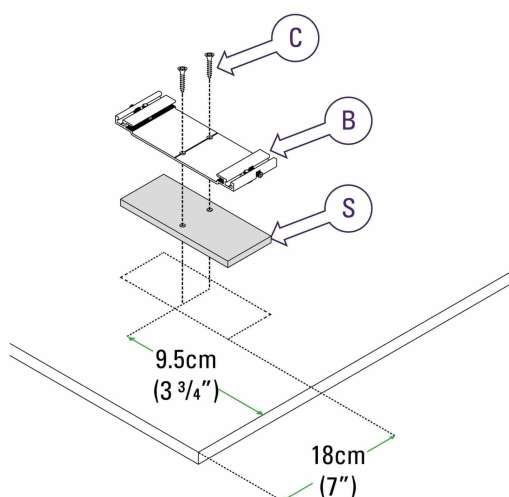

Place the first base bracket (part B) 18cm (7") from the edge and 9.5cm (3 3/4") from the front of your bench. Use a Posi head screwdriver to tighten screws.



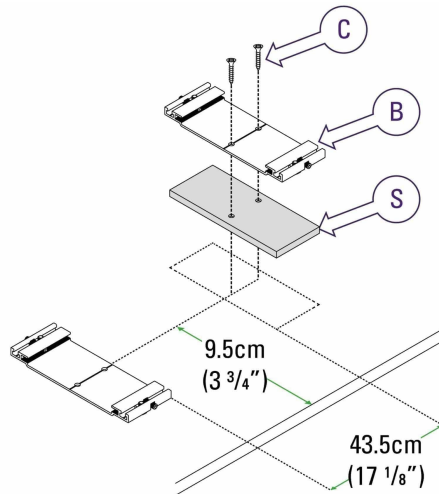

Place the following base brackets (part B) 43.5cm (17 1/8") from the edge of the previous base bracket and 9.5cm (3 3/4") from the front. Use a Posi head screwdriver to tighten screws.

Continue placing the rest of the base brackets in this way.

NOTE: If you had to place spacing pieces under any of the base brackets it is recommended the thread is used (as seen in the work bench flatness test – (see 3.2 to find out how to do the flatness test >). Measure to the top surface of each base bracket to check they differ by no more than 3mm (1/8").



3.4 Fix the cutter to the base brackets on your non-Keencut Bench

IMPORTANT: This step should be carried out by two people to prevent damage or injury

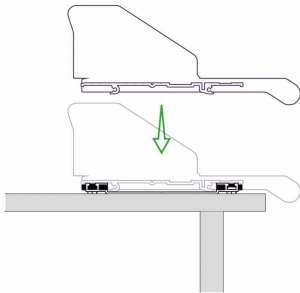

Centralise and lower the cutter slowly onto the base brackets.

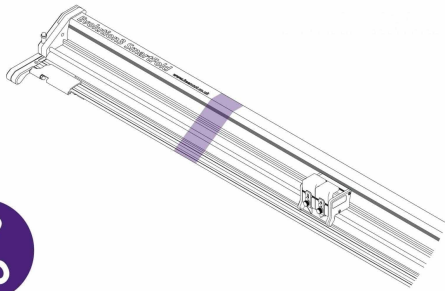

Once the SmartFold is in place, use scissors to remove the film packaging.

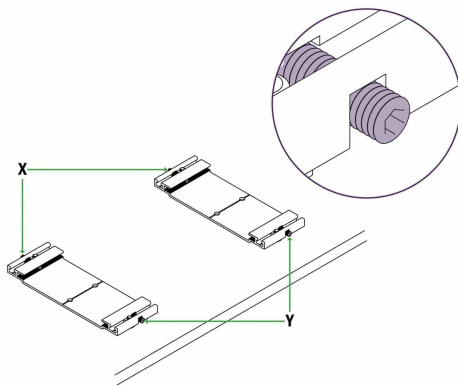

The base brackets have 2 grub screws each located at the front and the back (see 'x' and 'y').



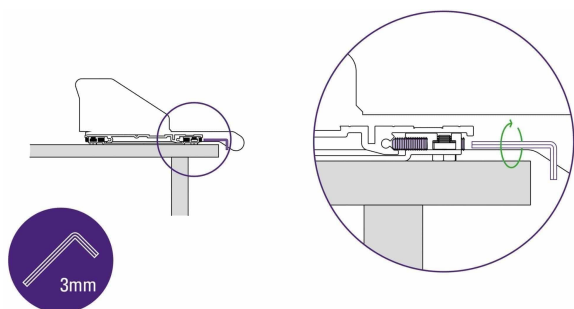

Use the long end of the 3mm Allen (hex) key rotate the grub screws in the front of the base brackets until you feel them come to a stop, do not tighten any further.



Do this gently

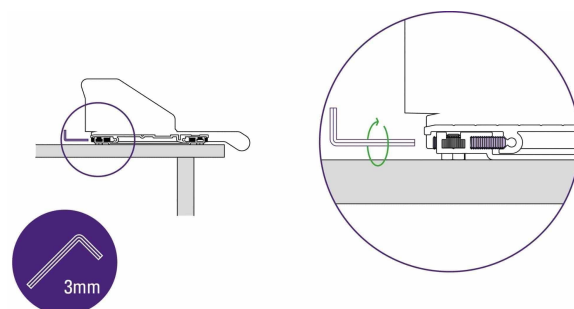

Repeat the process on the grub screws at the back of the base brackets.



Do this gently

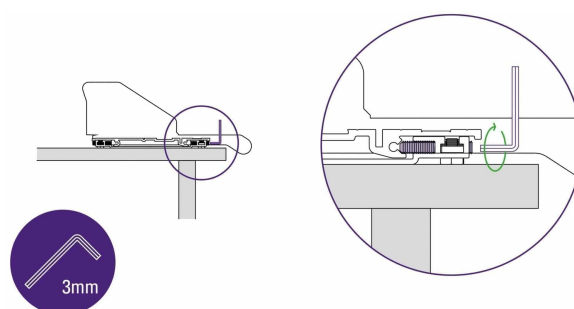

Use the 3mm Allen (hex) key to firmly tighten the grub screws in the front of the base brackets.



Do this firmly



3.5 Attach the cutter arms to your non-Keencut Bench

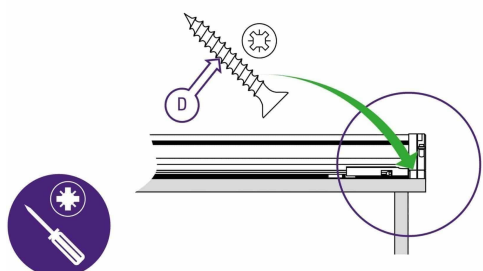

Take the long screws (part D) and a Posi head screwdriver to the highlighted section of the SmartFold.

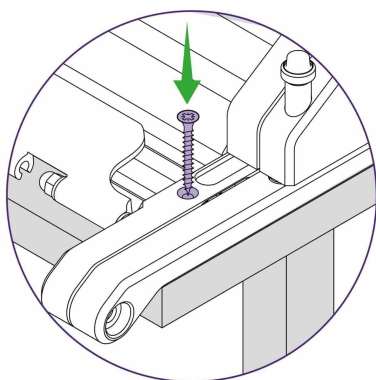

Fix the arm to the work surface but do not tighten at this stage. Repeat on the other end of your SmartFold.



Do this gently

IMPORTANT: It is essential to remove cutter head before folding

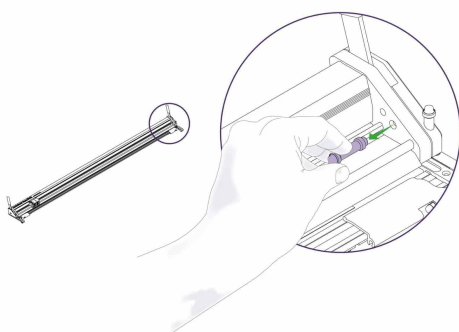

Pull and remove end stop.



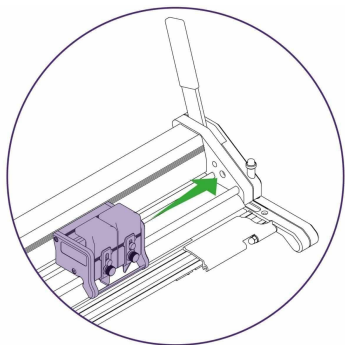

Slide the cutting head to the right.

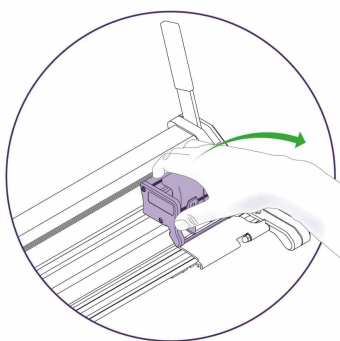

Gently lift to remove the cutter head, then replace end stop.



Do this gently

IMPORTANT: This next step may require more than one person on longer cutters to prevent damage or injury

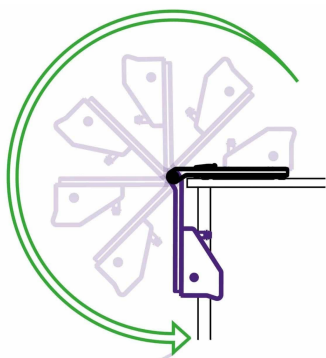

Grip the cutter bar firmly, lift carefully and swing over the edge of the bench, bring gently to a stop when vertical.



Be careful when lifting



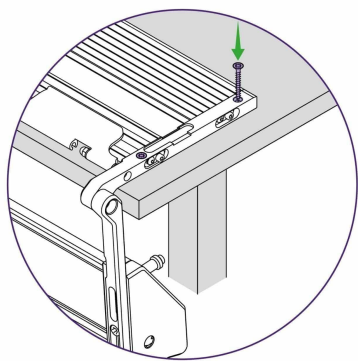

Insert the highlighted screw but do not tighten. Repeat this step on the other side of your SmartFold.



Do this gently

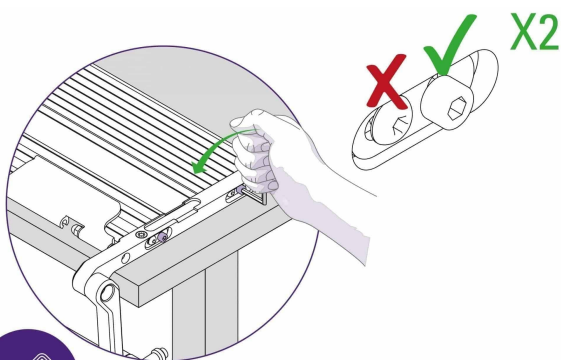

Use 4mm Allen (hex) Key to loosen the cap screws by one full turn at the end of the SmartFold.

DO NOT loosen the domed head screws that have red paint on them.

Repeat this step on the other end of your SmartFold.



4. Finish Assembly and Calibration

4.1 Fit the Lift-and-Hover levers

See how to fit the Lift-and-Hover levers in this video >

IMPORTANT: The Lift-and-Hover levers (part E) are fixed into openings at each end of the machine and it is essential they are installed facing the correct way or they can damage the internal mechanism when tightened in place.

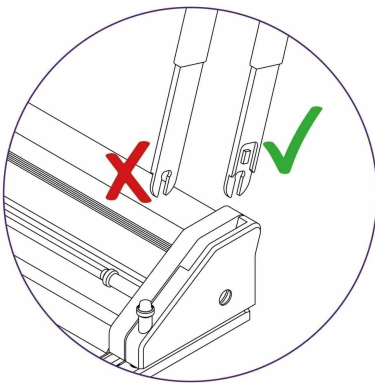

Ensure the flat face of the lever is facing to the centre of the unit.

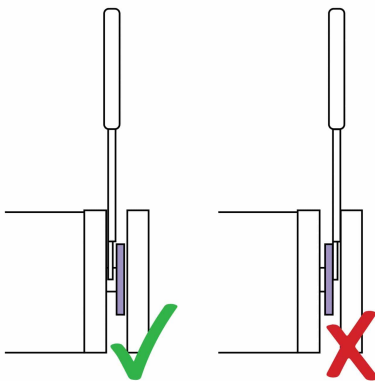

Insert the handle between the body of the cutter bar and the steel plate that can be seen within opening.

TIP: You can use the 3mm Allen key to move the steel plate within the opening if you are struggling to insert the handle.



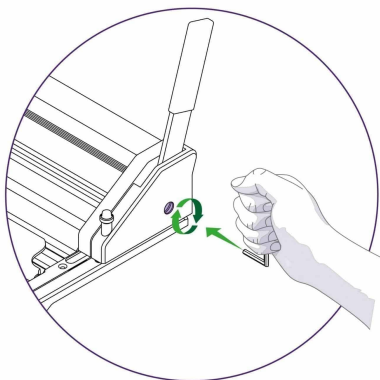

Use the 5mm Allen (hex) key and insert it into highlighted section. Tighten fully.



Do this firmly

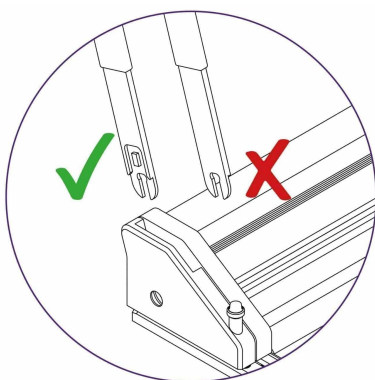

Repeat these steps on the other end again ensuring the flat face of the lever is facing to the centre of the unit and the handle is inserted between the body of the cutter bar and the steel plate. Tighten the fixing screw firmly.



4.2 Hover action adjustment

See how to adjust the hover action in this video >

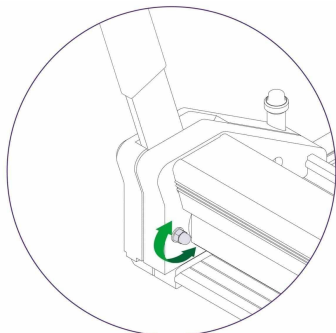

Use an 8mm spanner/wrench to adjust the highlighted nut to obtain the best setting to hold or hover the cutter bar above the base plate.

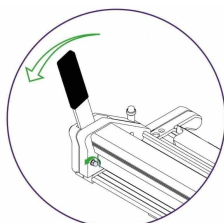
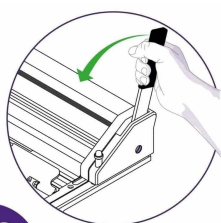

Loosen the nut a small amount, raise the cutter bar using the lever then carefully release the lever and the cutter bar should lower itself to the base plate. If not loosen the nut a small amount more.

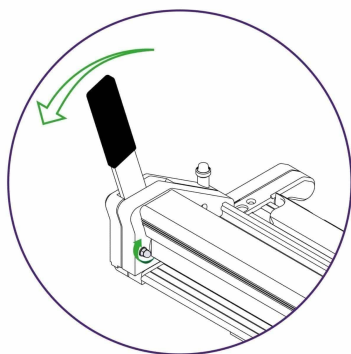

Raise the cutter bar and tighten the nut a very small amount until the cutter bar is held from falling.



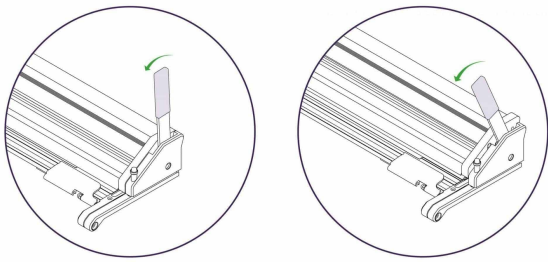

Nudge the lever towards you in small movements, if the cutter bar then falls tighten the adjustment nut a very small amount and try again.



www.keencut.com
+44 (0) 1536 263158
+1 (716) 748 6203

sales@keencut.co.uk (UK HQ)
sales@keencut.com (US sales)

The world's finest cutting machines

Scan the QR code or
[click here to view this document online >](#)



4.3 Clamp adjustment

See how to adjust the clamping mechanism in this video >

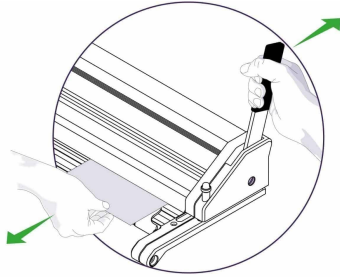

Insert a piece of A4/letter paper under the cutter bar at one end, push the lever away from you to fully lower the cutter bar. Test the paper is clamped by trying to move it.

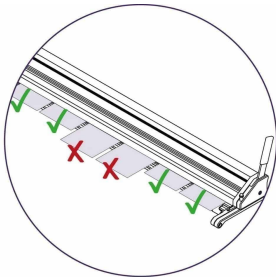

Repeat over the length of your SmartFold and take note of the areas where the paper moves when you pull it.

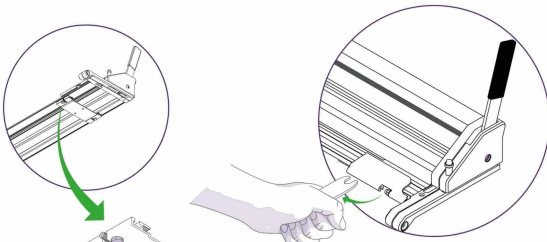

In those areas that the paper is not clamped, use the 10mm spanner/wrench to adjust the hex screws underneath the adjacent base brackets. There are two adjustment screws on each base bracket and they must both be adjusted by the same amount. Turn the hex screw just enough to correct the clamping in that area.



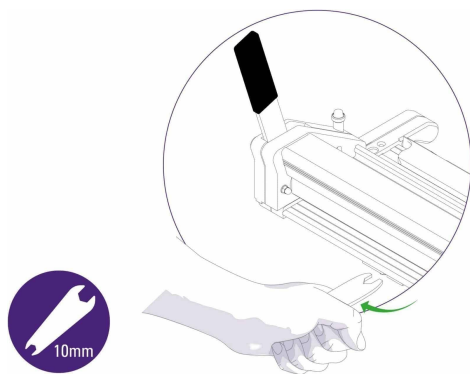

Access rear hex screw from the back of the machine. Adjust by the same amount as above.

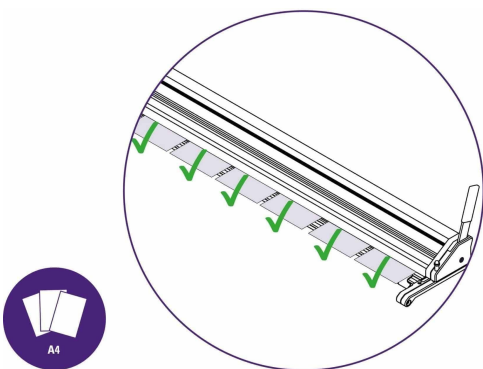

Repeat the clamping check along the whole length of the cutter bar, make further adjustments until the paper is clamped along the whole length of the machine.

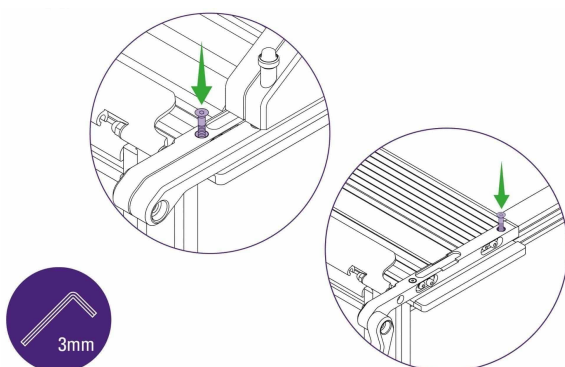

Using a Posi screwdriver (if fitting to custom made bench) or 3mm Allen (hex) key (if fitting to a SmartFold bench) fully tighten the vertical screws fixing the arm to the work surface (two at each end of the SmartFold).



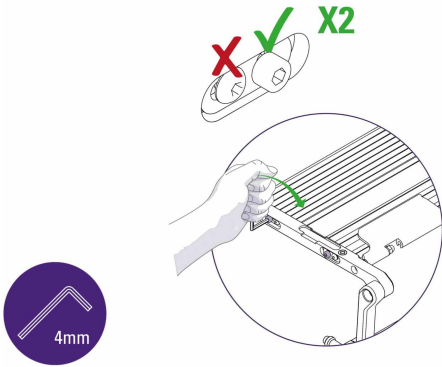

Use 4mm Allen (hex) key to tighten the two cap screws, one located at each end of the SmartFold.

DO NOT loosen or tighten the red painted dome head bolts. Repeat this step on the other end of your SmartFold.

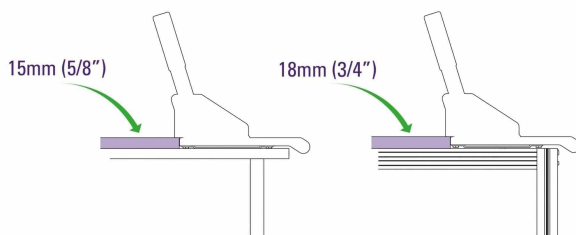

If fitting the SmartFold to a custom-made worksurface build the surface up behind the base plate by 15mm ($\frac{5}{8}$ ") using MDF, plywood or similar, to level the work surface with that of the cutter.

When fitting to a SmartFold Bench, the 18mm ($\frac{3}{4}$ ") thick bench worktop should now be installed.



4.4 Remove cutter bar sag

See how to remove cutter bar sag in this video >

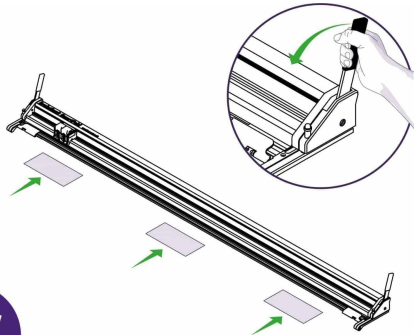

Place 3 pieces of 3mm ($\frac{1}{8}$ ") thick board (PVC Foamboard, ACP or similar) under each end and the middle of the cutter bar. Lower the cutter bar.

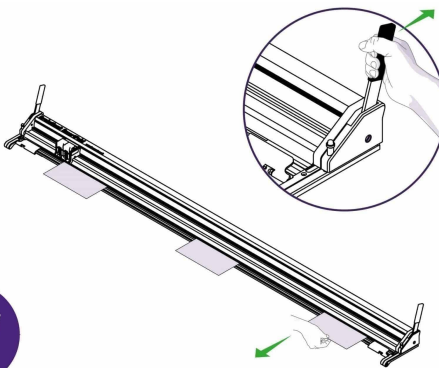

Test each of the boards to check they are clamped in position. Remove the central board and check the gap under the cutter bar is only a little below 3mm ($\frac{1}{8}$ "). This gap can be adjusted.

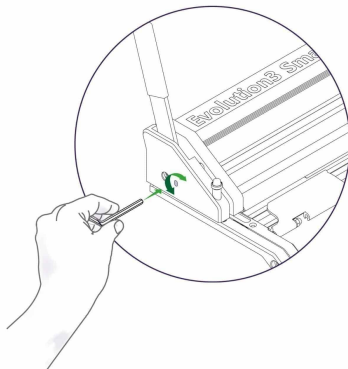

Use the 4mm Allen (hex) key in the opening on the left hand end of the cutter to adjust the cutter bar sag. Turn clockwise to raise the clamp in the centre.

NOTE: the screw has to be accessed using the long end of the Allen (hex) key, it may be difficult to get enough pressure when raising the cutter bar on longer versions of SmartFold, use grips on the short end of the Allen (hex) key to assist.



5. Using your machine

5.1 Register your machine



Registering your SmartFold machine will activate your 5 year guarantee.

[Register your cutter to activate your guarantee >](#)



5.2 User guide



See the Evolution3 SmartFold User Guide for advice on cutting techniques, using the different cutting heads and care and maintenance of your machine.

[Visit the Evolution3 SmartFold User Guide >](#)



www.keencut.com
+44 (0) 1536 263158
+1 (716) 748 6203

sales@keencut.co.uk (UK HQ)
sales@keencut.com (US sales)

The world's finest cutting machines

Scan the QR code or
[click here to view this document online >](#)

