

INTERACTIVE MOBILE MEDIA CABINET

4544 (OAK OR MAPLE)
ASSEMBLY INSTRUCTIONS

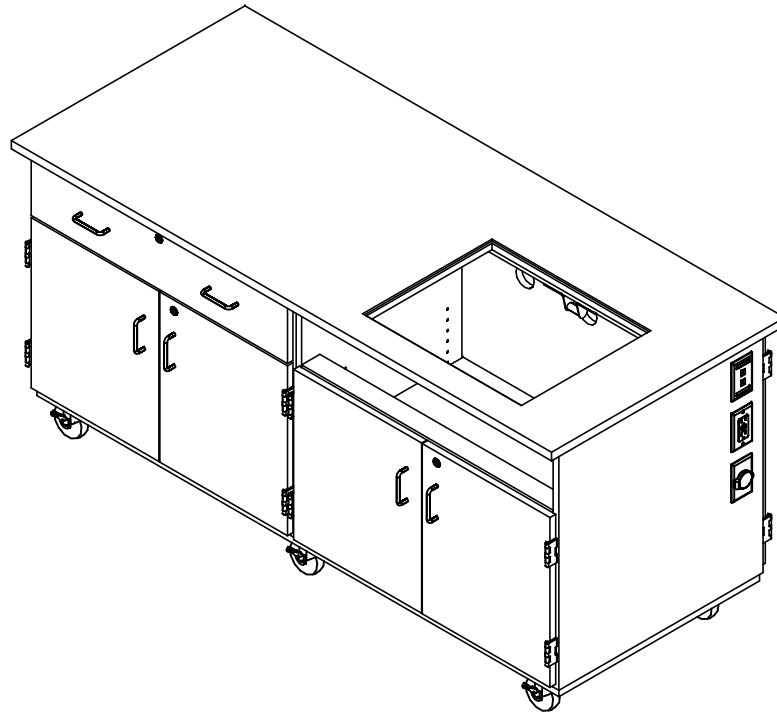

NOTE:

1. MODEL VIEWS MAY NOT REPRESENT EXACT MODEL PURCHASED

DWN BY:	EMK	DWN DATE:	2/10/15
APR BY:		DATE APR:	
APR BY:		DATE APR:	

UNLESS OTHERWISE SPECIFIED
DIMENSION ARE IN INCHES
CABINET SQUARENESS $\pm .0625$
FRACTIONAL VALUES $\pm 1/32"$
- ALL VALUES \pm OVERALL -



300 South Krueger Street
Suring, WI 54174
diversifiedwoodcrafts.com

TITLE:
INTERACTIVE MOBILE MEDIA CABINET
ASSEMBLY INSTRUCTIONS

A	CREATED ASSEMBLY INSTRUCTIONS	2/10/15	EMK	-
REV.	DESCRIPTION	DATE	NAME	ECN NO.

REVISION LEVEL

THIS DRAWING IS THE SOLE PROPERTY OF
DIVERSIFIED WOOD CRAFTS. IT MAY NOT
BE ALTERED OR CHANGED WITHOUT
PERMISSION

DRAWING NUMBER:

4544

SCALE:

NTS

SHEET:

1 OF 5

REVISION:

REV A

TOOLS REQUIRED

DRILL

SILICONE ADHESIVE

ASSEMBLY COMPONENTS

ITEMS INCLUDED	PART #	PART DESCRIPTION	QTY
CABINET	N/A	CABINET - 72"W X 28"D X 35"H	1
TOP	240593	TOP,PHENOLIC,1.00X32X74,BLK	1
MONITOR ARM	232917	ARM,FLAT PANEL,NOVA FPA-8-2006	1
KEYBOARD TRAY	240671	TRAY,KEYBOARD,SLIDE OUT,#632.67.300	1
EXTENSION CORD	100036	ELECTRICAL EXTENSION CORD	1
PLEXIGLASS COVER	241061	COVER PANEL,LEXAN .25X17.69X21.69	1
TOP	240594	TOP,PHENOLIC,0.25X17.69X21.69	1

NOTE:

1.

DWN BY:	EMK	DWN DATE:	2/10/15
APR BY:		DATE APR:	
APR BY:		DATE APR:	

UNLESS OTHERWISE SPECIFIED
DIMENSION ARE IN INCHES
CABINET SQUARENESS $\pm .0625$
FRACTIONAL VALUES $\pm 1/32"$
- ALL VALUES \pm OVERALL -



300 South Krueger Street
Suring, WI 54174
diversifiedwoodcrafts.com

TITLE:
INTERACTIVE MOBILE MEDIA CABINET
TOOLS AND ASSEMBLY COMPONENTS

A	CREATED ASSEMBLY INSTRUCTIONS	2/10/15	EMK	-
REV.	DESCRIPTION	DATE	NAME	ECN NO.

REVISION LEVEL

THIS DRAWING IS THE SOLE PROPERTY OF
DIVERSIFIED WOOD CRAFTS. IT MAY NOT
BE ALTERED OR CHANGED WITHOUT
PERMISSION

DRAWING NUMBER:

4544

SCALE:

NTS

SHEET:

2 OF 5

REVISION:

REV A



TOP VIEW SHOWN

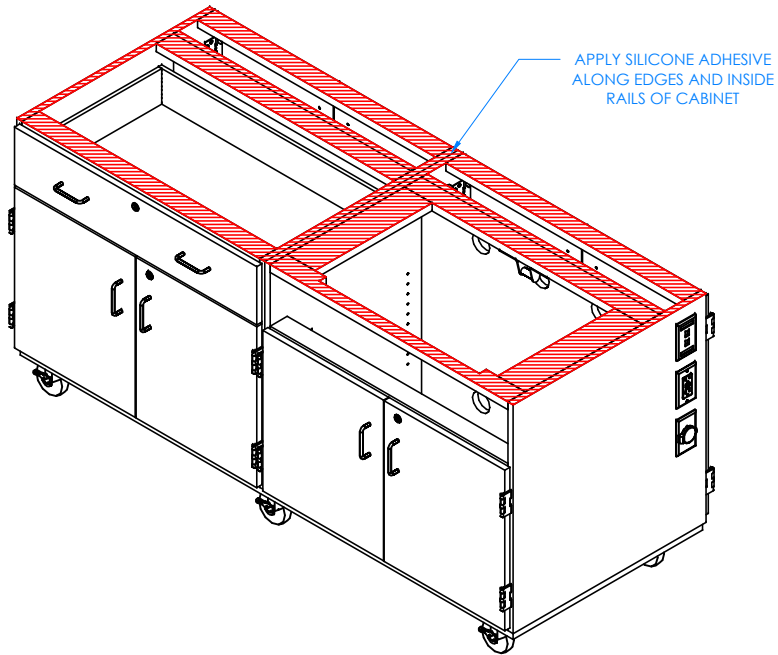

STEP 3:

APPLY SILICONE ADHESIVE ON TOP EDGES AND ON INSIDE RAILS. PLACE TOP ON UNIT WITH PROPER OVERHANG (1" OVERHANG ON SIDES AND 2" ON FRONT AND BACK). TOP IS CENTERED AT THOSE DIMENSIONS. ALLOW UNIT TO SIT FOR 24 HOURS BEFORE USING TO ALLOW SILICONE TO CURE.

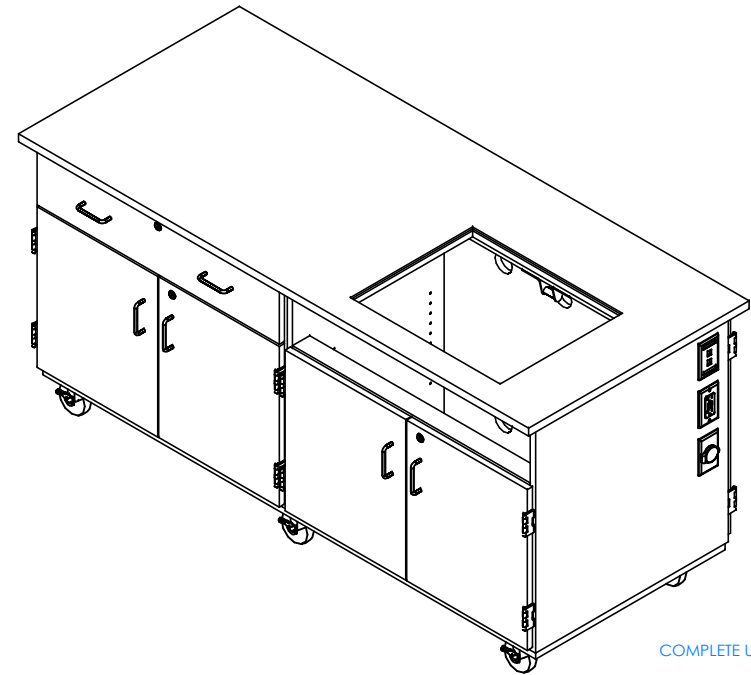

STEP 4:

SET PLEXIGLASS COVER AND REMOVABLE TOP IN PLACE (NOT SHOWN).
PLACE UNIT IN DESIRED LOCATION.

NOTE:

1.

DWN BY:	EMK	DWN DATE:	2/10/15
APR BY:		DATE	
APR BY:		DATE	

UNLESS OTHERWISE SPECIFIED
DIMENSION ARE IN INCHES
CABINET SQUARENESS $\pm .0625$
FRACTIONAL VALUES $\pm 1/32"$
- ALL VALUES \pm OVERALL -

THIS DRAWING IS THE SOLE PROPERTY OF
DIVERSIFIED WOOD CRAFTS. IT MAY NOT
BE ALTERED OR CHANGED WITHOUT
PERMISSION



300 South Krueger Street
Suring, WI 54174
diversifiedwoodcrafts.com

TITLE:
INTERACTIVE MOBILE MEDIA CABINET
ASSEMBLY INSTRUCTIONS

A	CREATED ASSEMBLY INSTRUCTIONS	2/10/15	EMK	-
REV.	DESCRIPTION	DATE	NAME	ECN NO.

REVISION LEVEL

DRAWING NUMBER:

4544

SCALE:

NTS

SHEET:

4 OF 5

REVISION:

REV A

TROUBLESHOOTING YOUR GFCI ELECTRICAL RECEPTACLE:

PLEASE NOTE: THROUGHOUT ANY OF THE FOLLOWING STEPS (PROCEDURES); IF YOU ARE NOT SURE YOU CAN DO THIS JOB SAFELY, AND COMPETENTLY, REFER THIS WORK TO QUALIFIED PROFESSIONAL!

If your unit comes equipped with a GFCI (Ground Fault Circuit Interrupter) electrical receptacle, and there is no power in the receptacle please consider/check the following:

- The extension cord (if being used) is working properly.
- The breaker hasn't been tripped, or turned off.

This type of GFCI has two testing-related buttons on it. One button is appropriately labeled "TEST", and the other button is labeled "RESET". To test the GFCI receptacle follow these steps:

- Plug in an appliance (lamp or night light) into the outlet. The light should now be on. Then press the "TEST" button on the GFCI. The GFCI "RESET" button should pop out, and the light should go out.
- If the "RESET" button pops out, but the light doesn't go out, the GFCI has been improperly wired. In this case please contact a certified professional. There may also be a problem with other wiring in the same circuit.
- If the "RESET" button doesn't pop out, the GFCI is defective, or malfunctioned, and should be replaced.
- If the GFCI is functioning properly, and the lamp goes out, press the "RESET" button to restore power to the outlet.

Conversely, if you have a GFI that has tripped (which is common) and it will not reset, you may have a wiring short in the circuit, a defective appliance on the circuit, or the GFI itself has become defective. To test a tripping GFCI follow these steps:

- Remove every appliance connected to the GFCI's circuit and reset it. If it doesn't reset there may either be a wiring fault behind a socket outlet, or your GFCI itself has become faulty.
- Make sure whatever you are plugging into the GFCI is dry and not damaged.
- Only plug in one item at a time. If you are plugging in a defective item it will cause the GFCI to trip, and that item therefore should be replaced.

If you are still having difficulty the easiest way to troubleshoot a GFI is to obtain a GFI tester, which is available at most hardware stores. It plugs into the GFI outlet, and will supply you with a "snapshot" of your connections, indicating wiring problems and/or the condition of the GFI. Another way to troubleshoot is to simply purchase a new GFI and install it.